

D500.RSX.MINI Curve LED Downlight

Datasheet



TRU-COLOUR®

Product Codes

Unit:	Series:	Colour temp. (K):	Beam Angle:	Color:	Driver:	Version:
D500.RSX.MINI	CR	2.7K (2700K) [Special Order] 3K (3000K)	15° (Special order) 36° 60° (Special order)	B (BLACK) W (WHITE)	PHASE (PHASE)	1.0

Dimensions (mm)

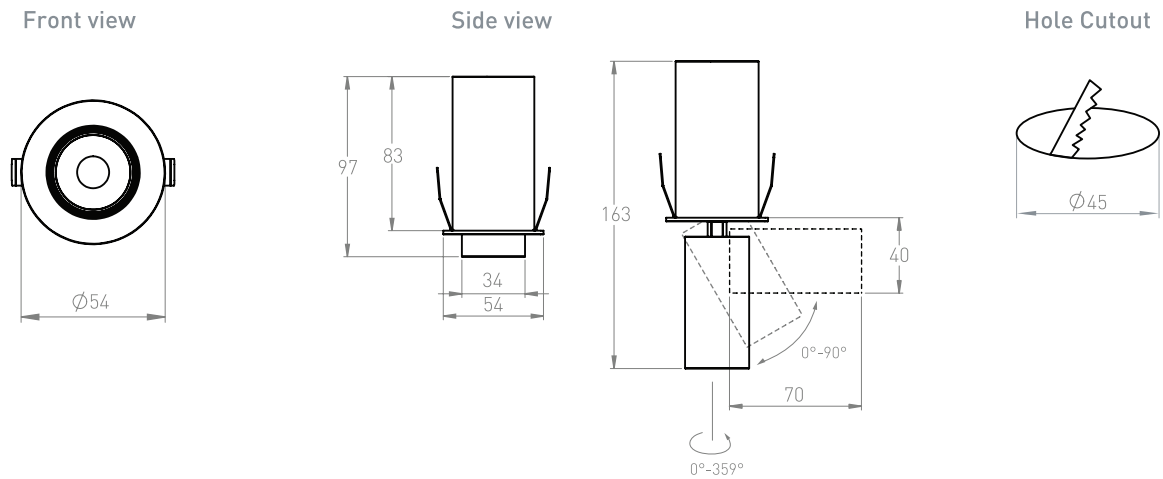

Photometrics

Photometric Diagram

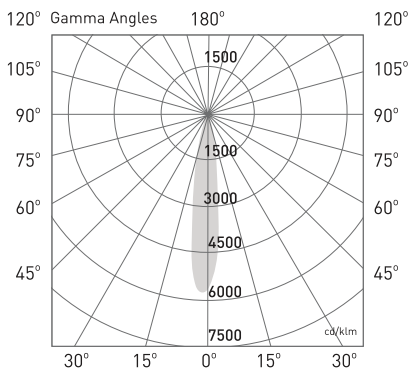

Beam Angle: 15°

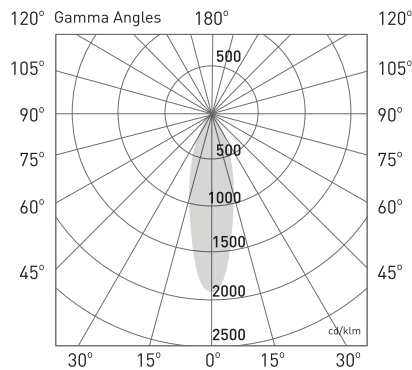

Beam Angle: 36°

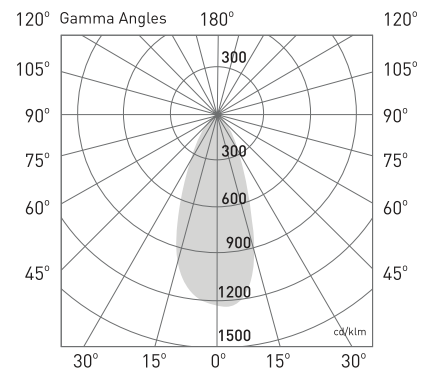

Beam Angle: 50°

CCT Outputs

CCT: 2700K
Efficacy: 84lm/W
Delivered lumen output: 505lm
CRI: 97
Standard deviation of colour Matching (SDCM): 2 MacAdam steps

CCT: 3000K
Efficacy: 86lm/W
Delivered lumen output: 515lm
CRI: 97
Standard deviation of colour Matching (SDCM): 2 MacAdam steps

Electrical

Input Voltage: AC220-240V	Power Usage: 6W	Current: 150mA	Driver Power Factor: >0.8	Dimming: Yes
-------------------------------------	---------------------------	--------------------------	-------------------------------------	------------------------

Physical

Gimbal Angle (°): 90°/359°	IP Rating: IP20	IK Rating: IK06
--------------------------------------	---------------------------	---------------------------

Operational

Ambient temp.: -20°C to 45°C	Lifetime L70, B10: 50,000 hrs	Warranty: 5 Years
--	---	-----------------------------

Installation

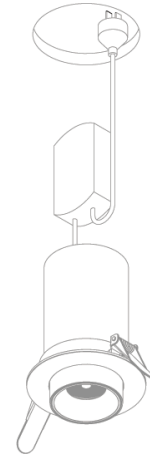
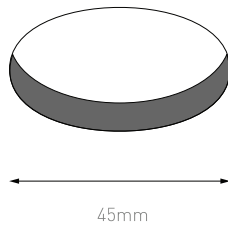

Step 1

Use a 45mm hole saw, cut a hole in the ceiling at the desired location.

Step 2

Plug the driver into a mounted general power outlet (GPO) in the ceiling.

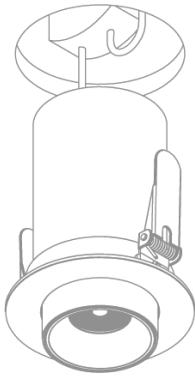

Step 3

Pull back the springs and insert the luminaire into the ceiling cavity. This luminaire can be covered and abutted with insulation.

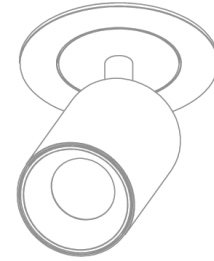

Step 4

Once the light is installed, pull down on the light to slide it out of the housing order to orient the light to the correct position.