

# D500.RSX.MINI Curve LED Downlight

## Datasheet



**TRU-COLOUR®**

### Product Codes

<b>Unit:</b> D500.RSX.MINI	<b>Series:</b> CR	<b>Colour temp. (K):</b> 3K (3000K)	<b>Beam Angle:</b> 36° 60° (Special order)	<b>Color:</b> B (BLACK) W (WHITE)	<b>Driver:</b> PHASE (PHASE)	<b>Version:</b> 1.0
-------------------------------	----------------------	--	--	---	---------------------------------	------------------------

### Dimensions (mm)

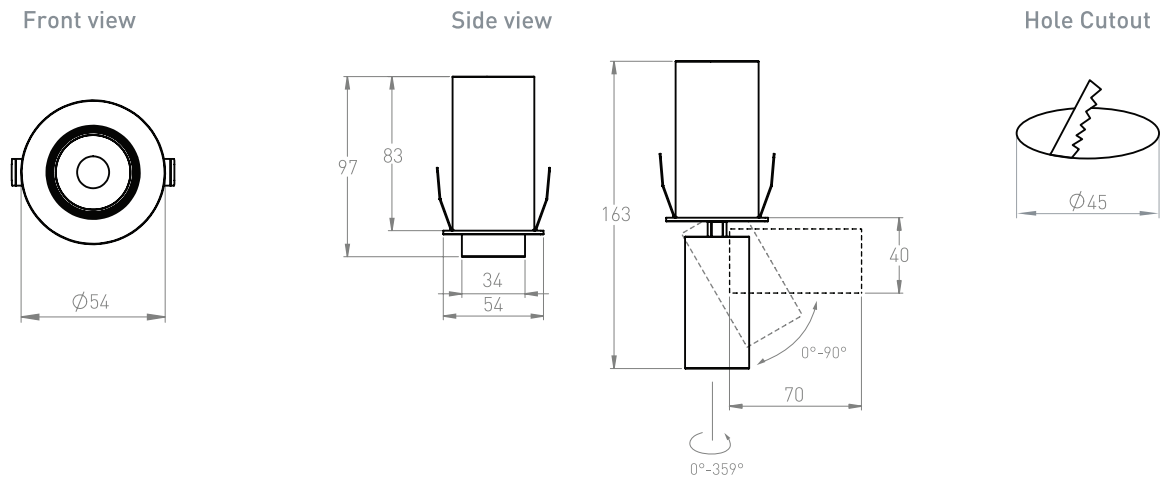

### Photometrics

**CCT:** 3000K  
**Efficacy:** 86lm/W  
**Delivered lumen output:** 515lm  
**CRI:** 97  
**Standard deviation of colour Matching (SDCM):** 2 MacAdam steps

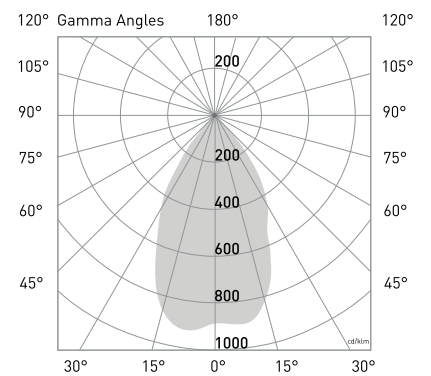
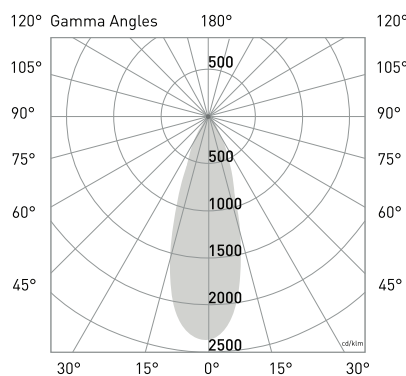

## Electrical

---

**Input Voltage:**  
AC220-240V

**Power Usage:**  
6W

**Current:**  
150mA

**Driver Power Factor:**  
>0.8

**Dimming:**  
Yes

## Physical

---

**Gimbal Angle (°):**  
90°/359°

**IP Rating:**  
IP20

**IK Rating:**  
IK06

## Operational

---

**Ambient temp.:**  
-20°C to 45°C

**Lifetime:**  
50,000 hrs

**Warranty:**  
5 Years

## Installation

---

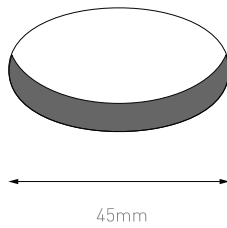

### Step 1

Use a 45mm hole saw, cut a hole in the ceiling at the desired location.

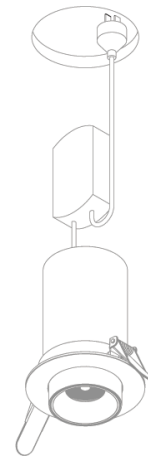

### Step 2

Plug the driver into a mounted general power outlet (GPO) in the ceiling.

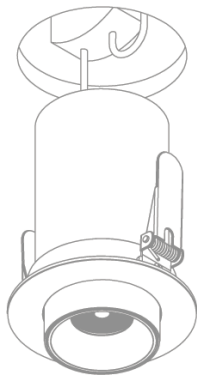

### Step 3

Pull back the springs and insert the luminaire into the ceiling cavity. This luminaire can be covered and abutted with insulation.

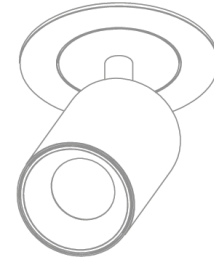

### Step 4

Once the light is installed, pull down on the light to slide it out of the housing order to orient the light to the correct position.