

# W100.SIP Curve LED Wall Light

## Datasheet



**TRU-COLOUR.**

### Product codes

<b>Unit:</b> W100.SIP	<b>Series:</b> CR	<b>Colour temp.:</b> 2.7K (2700K) 3K (3000K)	<b>Beam angle (°):</b> 360 (360°)	<b>Colour:</b> W (White) B (Black)	<b>Input voltage:</b> 24V	<b>Version:</b> 1.0
--------------------------	----------------------	--	--------------------------------------	--	------------------------------	------------------------

### Dimensions (mm)

Front view

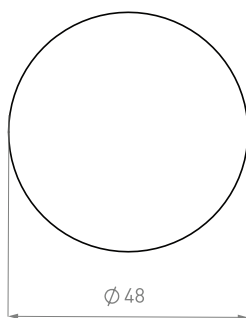

Side view

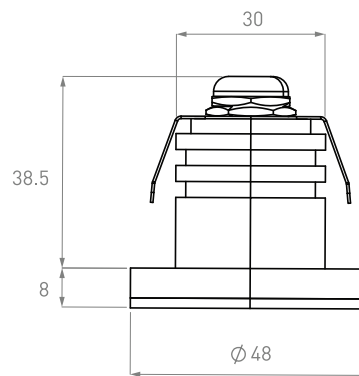

Hole Cutout

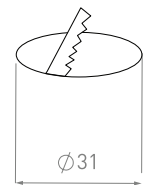

### Photometrics

#### Photometric Diagrams

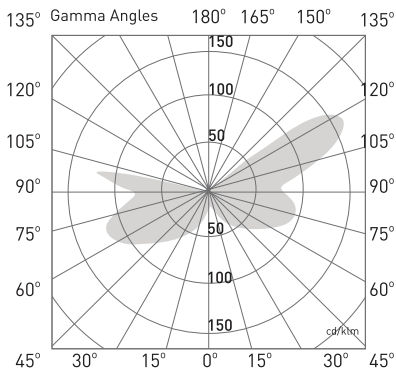

#### CCT Outputs

**CCT:** 2700K, 3000K  
**Efficacy:** 75lm/W  
**Delivered lumen output:** 74lm/W, 75lm/W  
**CRI:** >98  
**Standard deviation of colour**  
**Matching [SDCM]:** 2 MacAdam steps

## Electrical

**Input voltage:**  
DC 24V

**Power usage:**  
1W

**Driver power factor:**  
>0.9

**IP rating:**  
IP65

**Dimmable:**  
No

## Operational

**Ambient Temp.:**  
-20°C to 50°C

**Lifetime:**  
70,000 hrs

**SDCM:**  
2MacAdam Steps

## Physical

**Warranty:**  
7 years

**Mounting type:**  
Surface-mounted

## Installation

### Method 1: Installation on False Layers (Wood, Plywood, Plasterboard, Metal, Rock, etc)

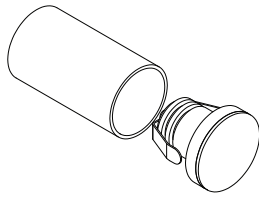

#### Step 1

Separate mounting sleeve from the luminaire. The mounting sleeve is not required for this installation.

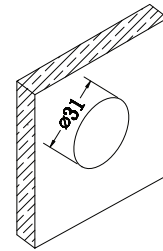

#### Step 2

Cut a 31mm diameter hole on the false layer at the desired location.

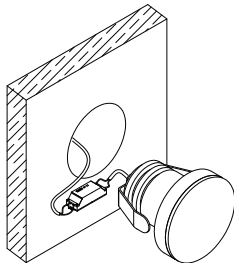

#### Step 3

Plug the driver into a mounted general power (GPO) in the wall.

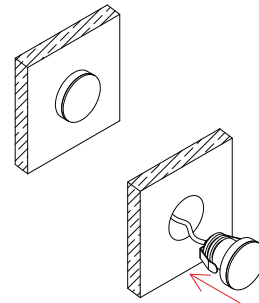

#### Step 4

Insert the luminaire into the hole, orient the luminaire as required.

## Installation

### Method 2: Installation on Brick Walls

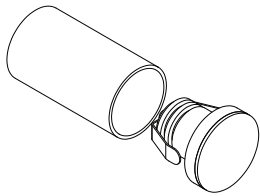

#### Step 1

Separate mounting sleeve from the luminaire.

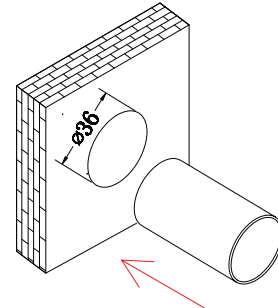

#### Step 2

Cut a 36mm hole in the wall at the desired location then embed the mounting sleeve. Paint the wall afterwards.

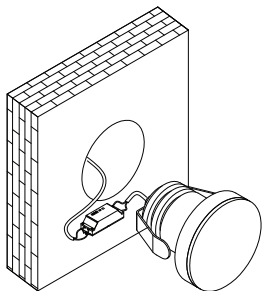

#### Step 3

Plug the driver into a mounted general power (GPO) in the wall.

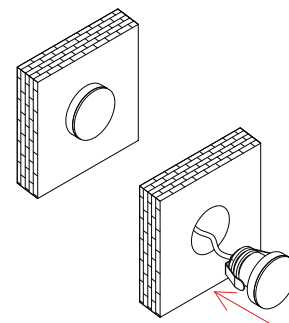

#### Step 4

Insert the luminaire into the mounting sleeve, orient the luminaire as required.