

D700.RSX Curve LED downlight

Datasheet



TRU-COLOUR®

Product codes

Unit:	Series:	Colour temp.:	Beam angle (°):	Colour:	Control:	Version:
D700.RSX	CR	2.7K (2700K) 3K (3000K)	24 (24°)(Special order) 36 (36°)	W (White) B (Black)	PHASE (PHASE)	1.0

Dimensions (mm)

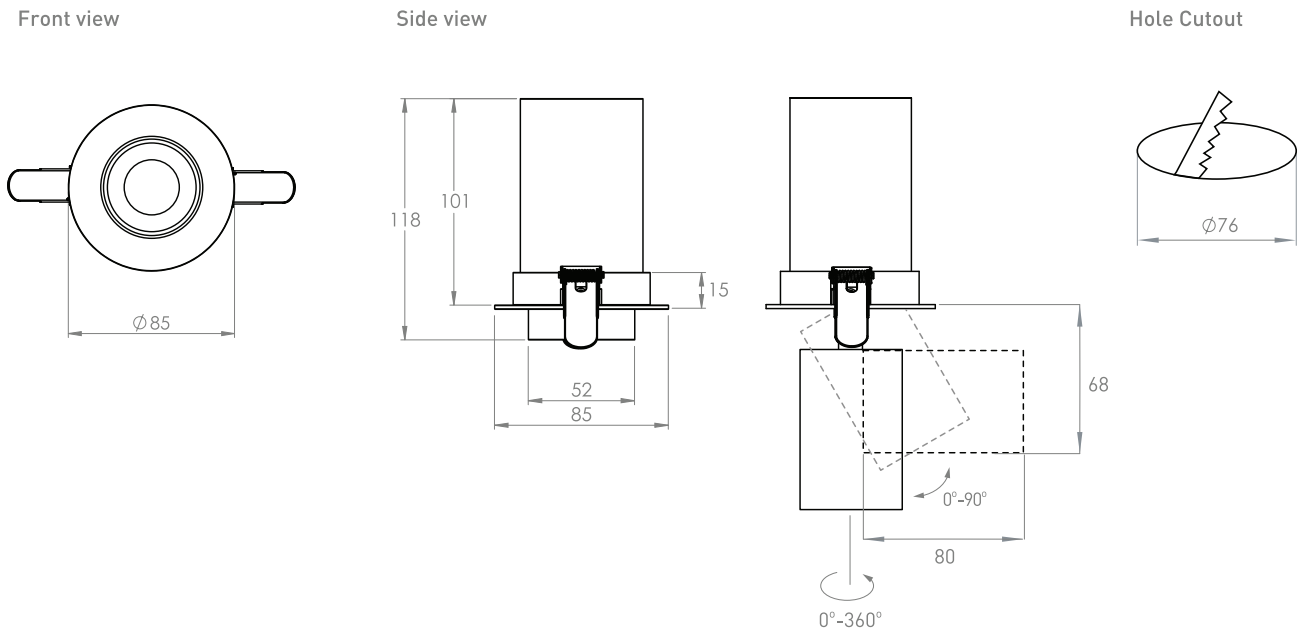

Photometrics

Photometric Diagrams

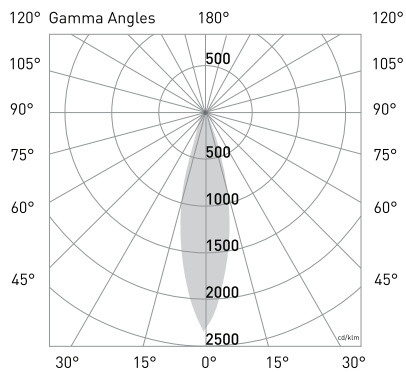

Beam Angle: 24°

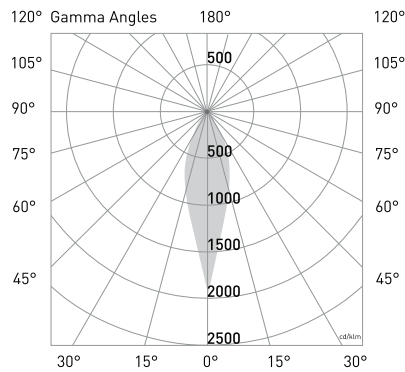

Beam Angle: 36°

CCT Output

CCT: 2700K
Efficacy: 74lm/W
Delivered lumen output: 745lm
CRI: 98

CCT: 3000K
Efficacy: 76lm/W
Delivered lumen output: 760lm
CRI: 98

Electrical

Input voltage:
240V

Power usage:
10W

Driver power factor:
>0.9

IP rating:
IP44

Surge protection:
3100V

Dimmable:
Yes

Physical

Mounting type:
Recessed

Operational

Lifetime L70, B10:
50,000 hrs (@TA25)

Thermal rating:
IC-4

SDCM:
3MacAdam Steps

Warranty:
7 years

Installation

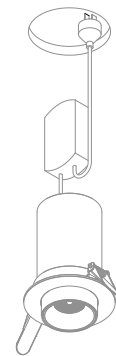
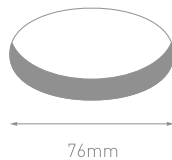

Step 1

Using a 76mm hole saw, cut a hole in the ceiling at the desired location.

Step 2

Plug the driver into a mounted general power outlet (GPO) in the ceiling.

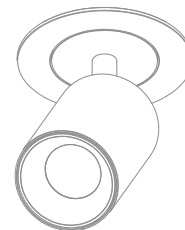
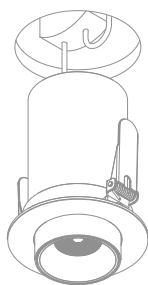

Step 3

Pull back the springs and insert the luminaire into the ceiling cavity. This luminaire can be covered and

Step 4

abuted with insulation. Once the light is installed, pull down on the light to slide it out of the housing in order to orient the light to the correct position.

abuted with insulation.